

Penn-Elcom offers a wide selection of casters for equipment racks, bass bins, storage containers, and more.

Blue 4" Heavy Duty Casters

Heavy duty casters for large rack cabinets and bass boxes. Features heavy gauge, zinc plated, pressed steel construction and a 4" blue wheel with roller bearings. Carrying weight per wheel: 330 lbs. Sold individually.



Fixed Caster

Dimensions: Mounting plate: 4.13" x 3.34", Overall height: 5.11". Mfg. #W8975. Sold individually.

#262-274 \$13.13 (1-9) \$12.34 (10-UP)

Swivel Caster

Dimensions: Mounting plate: 3.1" x 3.88", Overall height: 5.2". Mfg. #W9000Z. Sold individually.



#262-270 \$18.64 (1-9) \$17.74 (10-UP)

Swivel Caster with Brake

Dimensions: Mounting plate: 3.88" x 3.1", Overall height: 5.2". Mfg. #W9008Z. Sold individually.



#262-276 \$23.64 (1-9) \$20.74 (10-UP)

Recessed Caster

Dimensions: Mounting plate: 3.9" x 3.85", Overall floor to cabinet bottom clearance: 1.49". Mfg. #W2100. Sold individually.

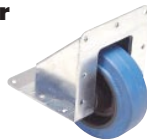

#262-278 \$21.73 (1-9) \$18.38 (10-UP)

2" Push-In Caster with Metal Socket

For heavier duty cabinet applications. Features pressed steel construction and a carrying weight capacity of 44 lbs. per wheel. Caster snaps in and out for removal later. Mfg. #W0958. Sold individually.



#262-287 \$6.73 (1-9) \$5.89 (10-UP)

2" Medium Duty Swivel Caster

Medium duty caster for rack cabinets, guitar cabinets and bass rigs. Heavy gauge zinc plated, pressed steel construction. 2" wheel and swivel roller bearings. Carrying weight: Approximately 80 lbs. per wheel. Mfg. #5291. Sold individually.



#262-272 \$4.72 (1-9) \$4.15 (10-UP)

Optional Caster Plate

Ideal for use when stacking multiple cabinets e.g. 4 x 10" and 4 x 12" half-stacks. For use with 2" casters above. Mfg. #W0961.



#262-288 ... 97¢ (1-9) 85¢ (10-49) 75¢ (50-UP)

Wheel Housing with 2" Caster Pair

Designed for use on a cabinet edge, this high quality 2" caster features a lightweight, high impact plastic housing with steel reinforcement brackets and a carrying capacity of 80 lbs. per wheel! Sold in pairs. Mfg. #W2001.



#262-282 . \$20.89 (1-9 PRS) \$18.37 (10 PRS-UP)

Heavy Duty Casters

- 250 lb. carrying capacity
- Case hardened double ball raceways provide extra capacity & durability
- Gray polyurethane on beige polyolefin wheel does not mark floors
- Wheel: 1-1/4" wide, available in 3", 4" & 5" diameters

The 3800 Series of casters is perfect for equipment racks, bass bins, movie and soundstage equipment, or storage containers for the weekend band to the professional touring musician. Dimensions: Top plate: 2-1/2" x 3-5/8"; Bolt hole pattern: 1-3/4" x 2-7/8", slotted to 3". Sold individually.



#262-080 #262-085 #262-087 #262-089 #262-090 #262-095

Part #	Wheel Diameter	Caster Type	Overall Height	Wheel Bearing	Price (1-9)	Price (10-UP)
262-080	3"	Swivel	3-3/4"	Sleeve	\$9.32	\$8.57
262-082	3"	Braked Swivel	3-3/4"	Sleeve	10.67	9.79
262-084	3"	Fixed/Rigid	3-3/4"	Sleeve	7.45	6.86
262-085	4"	Swivel	4-15/16"	Ball	9.57	8.79
262-087	4"	Braked Swivel	4-15/16"	Ball	12.27	11.30
262-089	4"	Fixed/Rigid	4-15/16"	Ball	8.25	8.00
262-090	5"	Swivel	5-3/4"	Ball	11.95	10.96
262-092	5"	Braked Swivel	5-3/4"	Ball	14.82	13.66
262-094	5"	Fixed/Rigid	5-3/4"	Ball	9.99	9.16
262-095	Quick Change Plate for Swivel Casters				4.18	3.93

Plastic Stacking Cabinet Corners 16-Pack



Popular plastic corners give your cabinets great looks and protection. Molded-in "chevrons" provide a stylish look, as well as interlocking to help prevent slippage when used with same-sized cabinets. Dimensions: 2-1/8" x 2-1/8" x 3-1/4". 16 pieces per package. Mfg. #PC123-16.



#262-834 \$7.99 LIST \$5.82 (1-9) \$5.29 (10-UP)

Metal 2-Leg Cabinet Corner

Stylish and durable powder-coated steel corners provide protection and a finished look for small to medium sized speaker cabinets and racks. Dimensions: 1.6" H x 1.6" W x 0.5" D. Sold individually. Mfg. #MC130.



#262-835 ... 99¢ LIST 63¢ (1-9) 57¢ (10-UP)

Also available in an economical 16-pack!

#262-836 (16-Pack) ... \$8.99 LIST \$6.96 (1-9 PKGS) \$6.38 (10 PKGS-UP)

Penn-Elcom ABS Connector Dishes

- Black ABS construction
- Dimensions: 3.36" x 3.36"



#260-287



#262-348

M1500: Pre-punched for mounting two 1/4" phone jacks.

#260-287 .. \$1.50 (1-9) \$1.35 (10-49) \$1.13 (50-UP)

M1503: Pre-punched for mounting one unified XLR connector e.g. Neutrik D, Speakon® NL4MP, Powercon, etc. & one 1/4" jack.

#262-346 .. \$1.75 (1-9) \$1.50 (10-49) \$1.15 (50-UP)

M1504: Pre-punched for mounting two unified XLR connectors e.g. Neutrik D, Speakon® NL4MP, Powercon, etc.

#262-348 .. \$1.75 (1-9) \$1.50 (10-49) \$1.15 (50-UP)

Penn-Elcom Ribbed Stacking Corner

This plastic corner is made of rugged black plastic for added protection and durability. Ribbed design adds strength and aids in non-slip stacking of multiple cabinets. 3" x 2-1/8" x 2-1/8". Mfg. #C1539.



#260-708 65¢ (1-9) 60¢ (10-UP)