

Home Audio / Video

Speakers

Dayton Audio Ultra Series

The best line of in-wall speakers Dayton Audio has to offer!



- Kevlar® cone woofers deliver bass and midrange clarity
- Pivoting silk dome tweeters
- Paintable frames and fine mesh grills allows matching to any décor
- Custom hand-tuned crossover networks

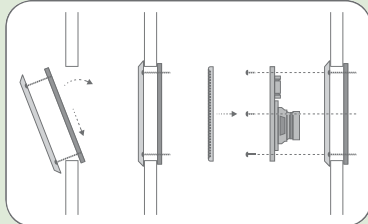

Designed by audiophiles for audiophiles, the Ultra Series from Dayton Audio combines powerful, yet refined Kevlar woofers and crisp, subtle silk dome drivers with hand-tuned crossovers to deliver a flat frequency response. The Dayton Ultra in-walls incorporate a unique 2-step mounting bracket that allows you to mount the frame, finish your décor, then load the speaker baffle.

US520W 5-1/4" 2-Way In-Wall Speaker Pair

- Small faceplate for space limited applications
- Long-throw 5-1/4" Kevlar® woofer with rubber surround
- Phase plug on woofer reduces distortion and compression
- 1" pivoting silk dome tweeter with ferrofluid cooling
- Polyswitch overdrive protection

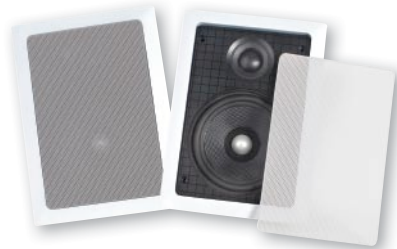

A speaker this small has no business sounding this good...but it does! The US520W's bass punch is delivered by a 5-1/4" Kevlar woofer while also performing as a high resolution mid-range. A 1" dome tweeter provides open, spacious high frequencies. An audiophile-tweaked crossover integrates these two drivers together in seamless fashion. Kitchen, sunroom, bath, and rear surround sound installations benefit from the compact size. Replacement metal grill #302-442.

Specifications: • Power handling: 40 watts RMS/80 watts max • Impedance: 8 ohms • Frequency response: 50-20,000 Hz • SPL: 91 dB 1W/1m • Dimensions: 9-1/4" H x 6-5/8" W x 2-3/8" D • Cutout size: 8-1/4" H x 5-9/16" W • Sold in pairs.

#300-460 \$179.99 LIST **\$133.12 PAIR**

US620W 6-1/2" 2-Way In-Wall Speaker Pair

- Great for medium-sized listening room installations
- Long-throw 6-1/2" Kevlar® woofer with rubber surround
- 1" pivoting silk dome tweeter with ferrofluid cooling
- IR knockout for discreet integration of infrared repeater system
- 12 dB/octave crossover with polyswitch overdrive protection



The US620W delivers solid, accurate bass while providing smooth high frequency response—and it's perfect for small-to-medium home theater or whole house audio applications. The 6-1/2" woofer's woven Kevlar® cone delivers dynamic bass/mid response, while the integrated phase plug reduces phase distortion. The 1" pivoting dome tweeter reproduces crisp, clean highs and is adjustable for improved stereo imaging. An IR knockout offers discreet integration of an infrared control system and accepts standard "tube" style IR receivers. US620W in-wall speakers put maximum sound where you need it, for minimum money. Replacement metal grill #302-440.

Specifications: • Woofer: 6-1/2" Kevlar cone • Tweeter: 1" pivoting silk dome • Power handling: 50 watts RMS/100 watts max • Impedance: 8 ohms • Frequency response: 45-20,000 Hz • Sensitivity: 91 dB 1W/1m • Dimensions: 12-1/8" H x 8-5/8" W x 3-1/8" D • Cutout size: 10-7/8" H x 7-3/8" W • Sold in pairs.

#300-462 \$219.99 LIST **\$167.85 PAIR**

US820W 8" 2-Way In-Wall Speaker Pair

- Perfect for home theater or music applications
- Superb imaging and stunning clarity
- 8" Kevlar® cone woofer with rubber surround delivers accurate bass
- 1" pivoting silk dome tweeter directs highs where you want them



Dayton Ultra Series 8" 2-way in-wall combines fidelity, reliability, and great value. A state-of-the-art tough Kevlar® cone gives the US820W the ability to reproduce more accurate bass than paper cone woofers. The US820W packs a punch and will perform effortlessly in the front channel or rear surround applications of any home theater system. Replacement metal grill #302-438.

Specifications: • Power handling: 60 watts RMS/120 watts max • Impedance: 8 ohms • Frequency response: 35-20,000 Hz • Sensitivity: 91 dB 1W/1m • Dimensions: 14-1/2" H x 10-1/2" W x 3-1/4" D • Cutout size: 13" H x 9" W • Sold in pairs.

#300-464 \$309.99 LIST **\$230.84 PAIR**

US830W 8" 3-Way In-Wall Speaker Pair

- The flagship of the Dayton Ultra Series brings movies and music to life
- 8" Kevlar® cone woofer with rubber surround
- 1-1/2" pivoting silk dome midrange
- 1" pivoting silk dome tweeter
- 12 dB/octave crossovers with polyswitch overdrive protection



Dayton Ultra Series US830W is an in-wall speaker that sounds like a spectacular floor-standing system. The speaker's woven Kevlar® cone woofer delivers unmatched bass; an integrated phase plug allows for greater detail with less distortion. A 1-1/2" silk dome midrange and ferrofluid cooled 1" silk dome tweeter provide crisp, clear mids and highs. Both midrange and tweeter pivot to provide perfect sound stage imaging, and a 12 dB/octave crossover network precisely integrates the bass, mids, and highs. Replacement grill #302-438.

Specifications: • Power handling: 60 watts RMS/120 watts max • Impedance: 8 ohms • Frequency response: 35-20,000 Hz • Sensitivity: 91 dB 1W/1m • Dimensions: 14-1/2" H x 10-1/2" W x 3-1/4" D • Cutout size: 13" H x 9" W • Sold in pairs.

#300-466 \$319.99 LIST **\$238.62 PAIR**